

SLO

1626A

EN

Campagnolo Power and Ultra Torque full set, also for Fulcrum Ultra Torque

SLO

Celotni set za Campagnolo® Power in Ultra-Torque in Fulcrum® Ultra-Torque

1

1626A set orodja vključuje podaljšek za demontažo ležaja (A), univerzalni snemalec (B), orodje za montažo ležaja (C), plastično zaščito za karbonsko gonilko (D), kovinski podaljšek (E) in tri zaščitne plastične ploščice za aluminijasto gonilko (F). Celotni set vključuje vsa potrebna orodja za popravila Campagnolo® in Fulcrum® Ultra Torque kot tudi za Campagnolo® Power Torque gonilke.

2

1626.1A Campagnolo® Power Torque set za nadgradnjo vsebuje podaljšek za demontažo ležaja (A), plastično zaščito za karbonsko gonilko (D), kovinski podaljšek (E) in tri zaščitne ploščice za aluminijasto gonilko (F). Set se uporablja skupaj s 1626/2 Snemalec ležajev Campagnolo Ultra Torque.

3

Za odstranitev Campagnolo® Ultra Torque aluminijastih gonilk, uporabimo tanko zaščitno ploščico (F) ki jo namestimo med gonilke in šalico gonilnega ležaja. Po odstranitvi vijaka iz gonilke, vstavimo kovinski podaljšek (E) v gonilko in z uporabo univerzalnega snemalca (B), odstranimo gonilko z vrtenjem osi (G) v smeri urinega kazalca. Os lahko vrtimo z uporabo viličastega ali drugega ključa velikosti 19mm.

4

Za demontažo Campagnolo® Power Torque karbonske gonilke, ponovimo postopek iz prejšnjega koraka pri aluminijasti gonilki, s to razliko da uporabimo debelejšo plastično zaščito (D).

5

Za demontažo ležaja iz gonilke, uporabimo univerzalni snemalec (B) skupaj s podaljškom za demontažo ležaja (A).

6

Za montažo ležaja na gonilko, uporabimo orodje za montažo ležaja (C) in kladivo.



Unior d.d.

Kovaška cesta 10

3214 Zreče, Slovenia

T: +386 3 757 81 00

www.uniorbiketools.com

90838921

 **UNIOR**[®]
BIKE TOOLS

uniorbiketools.com



1

1

1626A set of tools includes bearing removal extension (A), universal puller (B), bearing installation tool (C), plastic protection plate for carbon crank (D), extension pin (E) and three protection plates for aluminum crank (F). This full set includes complete crank and bearing removal and installation tools for Campagnolo® and Fulcrum® Ultra Torque crank sets as well as for Campagnolo® Power Torque system.

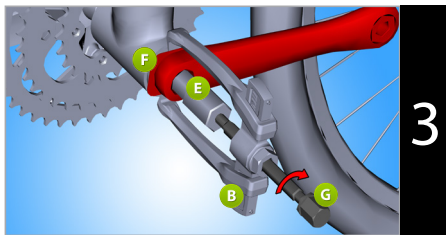

2

2

1626.1A Campagnolo® Power Torque upgrade set includes bearing removal extension (A), plastic protection plate for carbon crank (D), extension pin (E) and three protection plates for aluminum crank (F). Set is used together with the 1626/2 Campagnolo® Ultra Torque set.

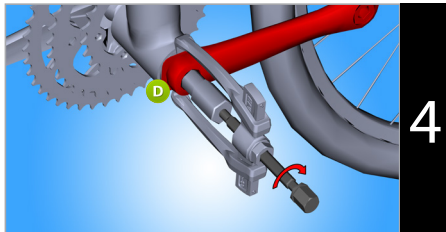

3

3

To remove the Campagnolo® Ultra Torque aluminum crank, we use the thin plate protector (F) which we firmly install between the crank and the bottom bracket cup. Afterwards we insert the pin extension (E) into the bottom bracket and with use of the universal puller (B), we remove the crank by turning the spindle (G) in the clockwise direction. The spindle can be turned with use of a 19mm wrench or ratchet.

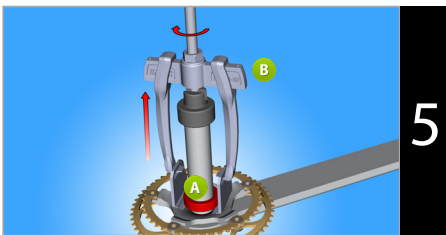

4

4

To remove the Campagnolo® Power Torque carbon crank, the same procedure is used as with the aluminum crank, except that we must use the thicker plastic protector (D).

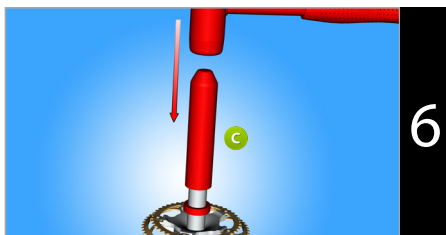

5

5

To remove the bearing from the crank, we use the universal puller (B) together with the bearing removal extension (A).

6

6

To install the bearing on the crank, we use the bearing installation tool (C) together with a hammer.